

Information note

ITU

Title	Infrastructure mapping for school connectivity
Dates	19/05/25 – 23/05/2025
Location	Geneva, Switzerland

1. TRAINING COURSE VENUE

The training is taking place at the Giga Connectivity Centre.

3rd Floor, Campus Biotech, 9 Chemin des Mines, 1202 Geneva, Switzerland

<https://maps.app.goo.gl/TjKdmQPE7Ba9eUQN8>

2. DETAILS OF ARRIVAL AND LOCAL TRANSPORT

From the Geneva Airport: Taxi or Geneva Public Transport

The bus *number 5* towards « Thônex, Vallard » will take you from Geneva Airport to Campus Biotech. The name of the closest bus stop to the Campus Biotech is « Nations », then you will have to walk 9 minutes.

The train CFF will take you from Geneva Airport to main train station Cornavin, and you will take the bus *number 1 or number 25* towards « Genève, Jardin Botanique » The name of the closest bus stop to the Campus Biotech is « Genève, Perle du Lac », then you will have to walk 3 minutes.

From the train station Cornavin: Taxi or Geneva Public Transport

The bus *number 1 or 25* towards « Genève, Perle du Lac » will take you from the train station Cornavin to Campus Biotech. The name of the closest bus stop to the Campus Biotech is « Genève, Perle du Lac », then you will have to walk 3 minutes.

The tramway *number 15* towards « Genève, Nations » will take you from the train station Cornavin to Campus Biotech. The name of the closest bus stop to the Campus Biotech is « Maison de la Paix », then you will have to walk 6 minutes.

3. ONSITE REGISTRATION

Collection of badges will take place on day 1 at 08:30 at the training course venue.

3. VISA REQUIREMENTS

Citizens of a number of countries are required to obtain a visa in order to enter Switzerland. The visa must be requested and obtained from the office (embassy or consulate) representing Switzerland in your country or, if there is no such office in your country, from the one that is closest to the country of departure.

IMPORTANT NOTICE FROM THE SWISS MISSION CONCERNING THE OBTENTION OF VISAS!

Switzerland has implemented necessary measures to facilitate the issuance of visas for official delegates invited to take part in conferences and international meetings with organizations having concluded a headquarters agreement as well as other persons invited in the framework of good offices.

The time needed for a visa request to be processed may vary from case to case and could also depend on local circumstances. It is therefore strongly recommended to take the necessary steps well in advance so visas can be issued as required. In general, exceptions excluded, visa requests can be lodged at the earliest three months before the departure date and at the latest twenty-one days before the departure date. All visa applicants should submit completed and signed application forms as well as all other necessary documents. Applications which are not complete will be delayed and not registered until complete.

Further information is available at: [Swiss Confederation - Federal Office for Migration](#)

More information on Visa requirements can also be found at:

<https://www.eda.admin.ch/missions/mission-onu-geneve/en/home/manual-regime-privileges-and-immunities/introduction/manual-visas.html>.

In case you need a visa invitation, please contact giga@itu.int as soon as possible

4. ACCOMODATION

Participants should make their own arrangements with regards to accomodation.

You will find a [LIST of hotels around Geneva offering special rates to ITU delegates](#).

Delegates attending ITU conferences and meetings may benefit from special rates in a number of hotels in Geneva. The procedure outlined below should be followed in order to simplify the reservation of hotel rooms on the special terms extended:

- Delegates must reserve their room directly at one of the hotels on this [list](#) **AND NOT** through any intermediary such as a travel agency or airline.
- They must confirm the booking by mailing this generic [confirmation form](#), which must include their credit card number by way of guarantee.
- When checking in, delegates may be required to provide evidence that they are attending an ITU meeting (and should in this case show their "Confirmation of Registration" letter).

Note: ITU has established this procedure to facilitate, but not to deal with, reservations.

More details are available on the ITU [Delegate's Corner \(itu.int\)](#).

Transportation - Geneva Transport Card

Hotels and residences in the canton of Geneva now provide a free " [Geneva Transport Card](#)". With this card, public transport in Geneva is free for the full duration of your stay.

This personal and non-transferable card will be given to you when you arrive at your accommodation. It permits unlimited travel on Geneva's public transport network (UNIRESO: bus (TPG), train (CFF) and boat (Mouettes Genevoises) for the full duration of your stay.

5. CURRENCY

The Swiss Franc (CHF) is the official currency of Switzerland.
1 CHF = 1.09 USD (as of 11 February 2025).

6. ELECTRICAL APPLIANCES

The country code of Switzerland is +41.

The **voltage** in Switzerland is similar to that in most other European countries, i.e. 230V/50Hz.
Switzerland uses two types of electric plug: type C (two pins) and type J (three pins).

Type C plug

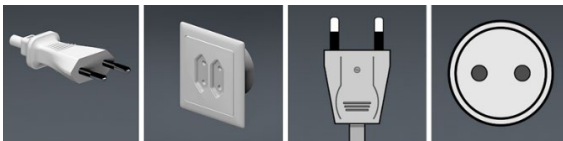

Type J plug

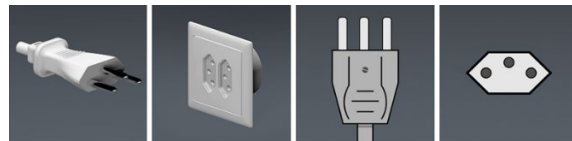

Source: International Electrotechnical Commission (IEC)

7. LANGUAGES

The training course will be held in English. The language spoken in Geneva, Switzerland is French, however, English is widely spoken.

8. SECURITY

ITU security/reception	119
Police	117
Fire	118
Ambulance	144

9. MEDICAL AND HEALTH

ITU Medical Service +41 22 730 5180 or +41 22 730 5397

Varembé Building, First Floor (V.16)
0830-1230 hours, and 1400-1730 hours

[Vermont: Grand-Pré medical centre](#)

24h/24 h – 7j/7j
+41 22 734 5150
9A, rue de Vermont

[SOS Médecins](#)

+41 22 748 4950
The doctor will come to your hotel or residence.

Pharmacies [Pharmacie populaire](#)+41 22 318 6912

67, rue de Montbrillant Pharmacie des Colombettes+41 22 740 0160
1 chemin des Colombettes

Pharmacies outside normal opening hours

After 23:00 hours, call 144 to find out which pharmacy is on special late-night duty.

10. WEATHER

Average Temperature in May: 20° / 9°

Time Zone: CEST

11. TRAINING COURSE COORDINATION

ITU coordinator
Name: Sebastien Peytrignet
Title: Project Officer (Capacity Development for School Connectivity)
Email address: sebastien.peytrignet@itu.int

ITU coordinator
Name: Alex Högback
Title: Project Manager
Email address: ituacademy@itu.int